

PROJECT:

CANYON RIDGE HIGH SCHOOL RE-ROOF

280 NORTH COLLEGE ROAD WEST
TWIN FALLS, IDAHO 83301

CLIENT:

TWIN FALLS SCHOOL DISTRICT #411

201 MAIN AVENUE
TWIN FALLS, IDAHO 83301

H U M M E L
ARCHITECTS

205 N. 10th Street Suite 300
Boise, Idaho 83702
208.343.7523

482 Constitution Way, Suite 111
Idaho Falls, ID 83402
208.343.7523

hummelarch.com

DRAWING SET:

DRAWING INDEX:

ARCHITECTURAL

GENERAL
G0.00 COVER SHEET

ARCHITECTURAL
A2.03 COMPOSITE ROOF PLAN

VICINITY MAP :

CANYON RIDGE HIGH SCHOOL

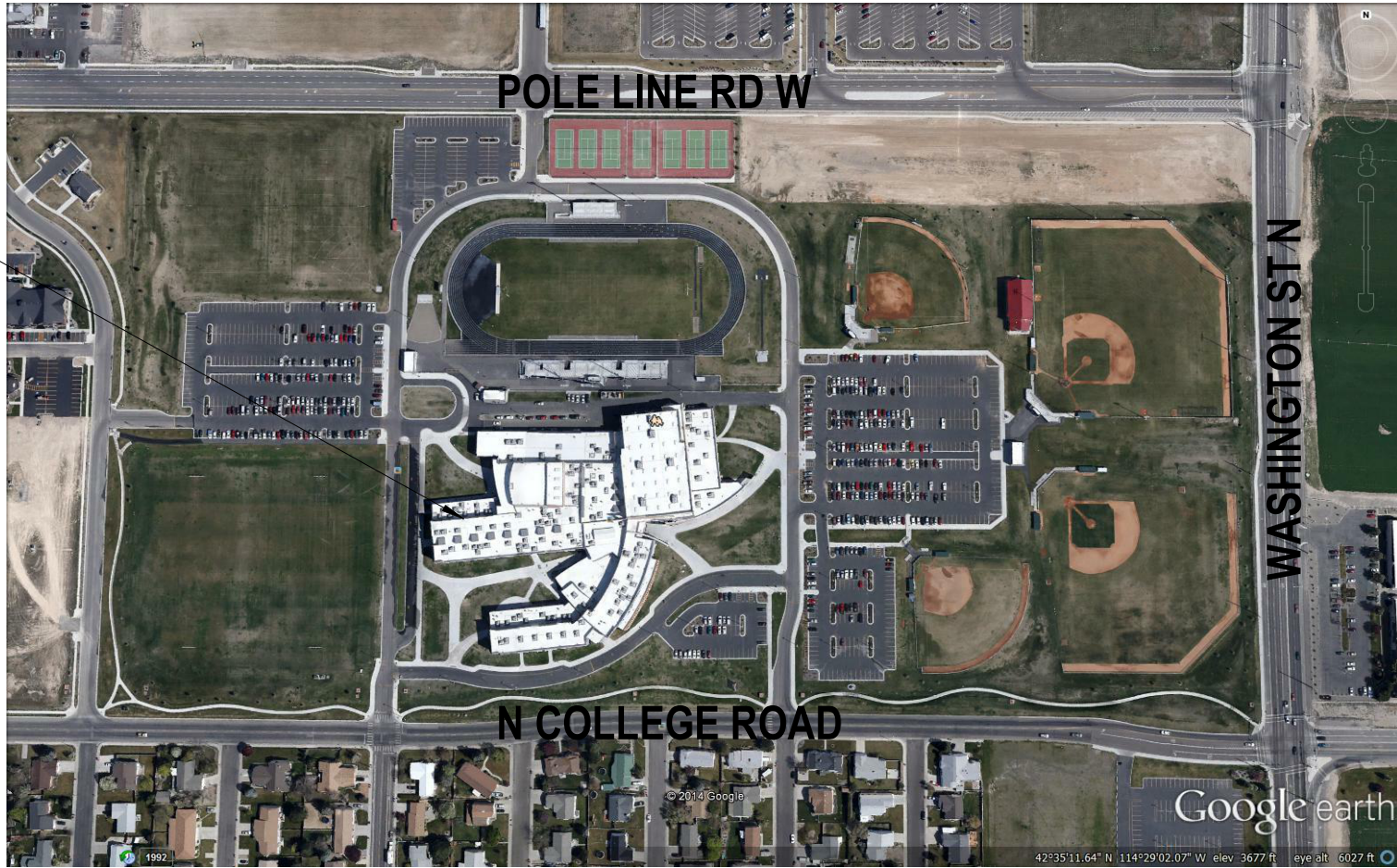
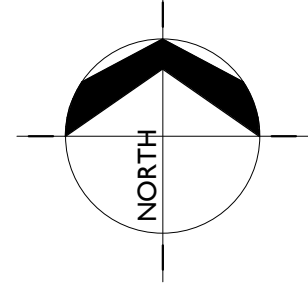

H . A . - J O B # 25155

CODE INFORMATION:

APPLICABLE CODES

2018 INTERNATIONAL BUILDING CODE
2018 INTERNATIONAL EXISTING BUILDING CODE

CANYON RIDGE HIGHSCHOOL

EXISTING SCHOOL

OCCUPANCY TYPE: E

CONSTRUCTION TYPE: TYPE II

OCCUPANT LOAD: UNCHANGED

DESCRIPTION OF WORK

WORK INCLUDES THE FOLLOWING:
• REPLACEMENT OF TPO ROOFING AND COPING CAP ON SELECT AREAS OF THE ROOF.

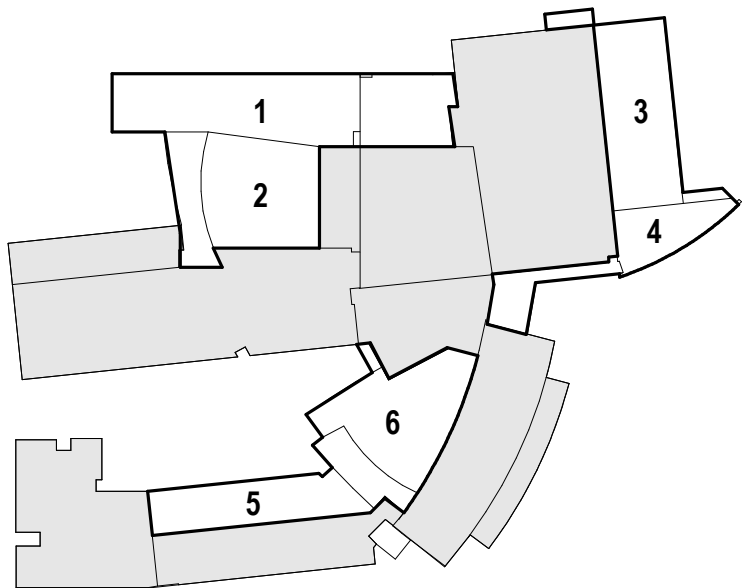

KEY PLAN

1" = 160'-0"

AREAS OF REPLACEMENT

1. MUSIC
2. AUDITORIUM
3. LOCKER ROOM
4. WEIGHT ROOM
5. POTTERY
6. LIBRARY

DECEMBER 12, 2025 - BID SET

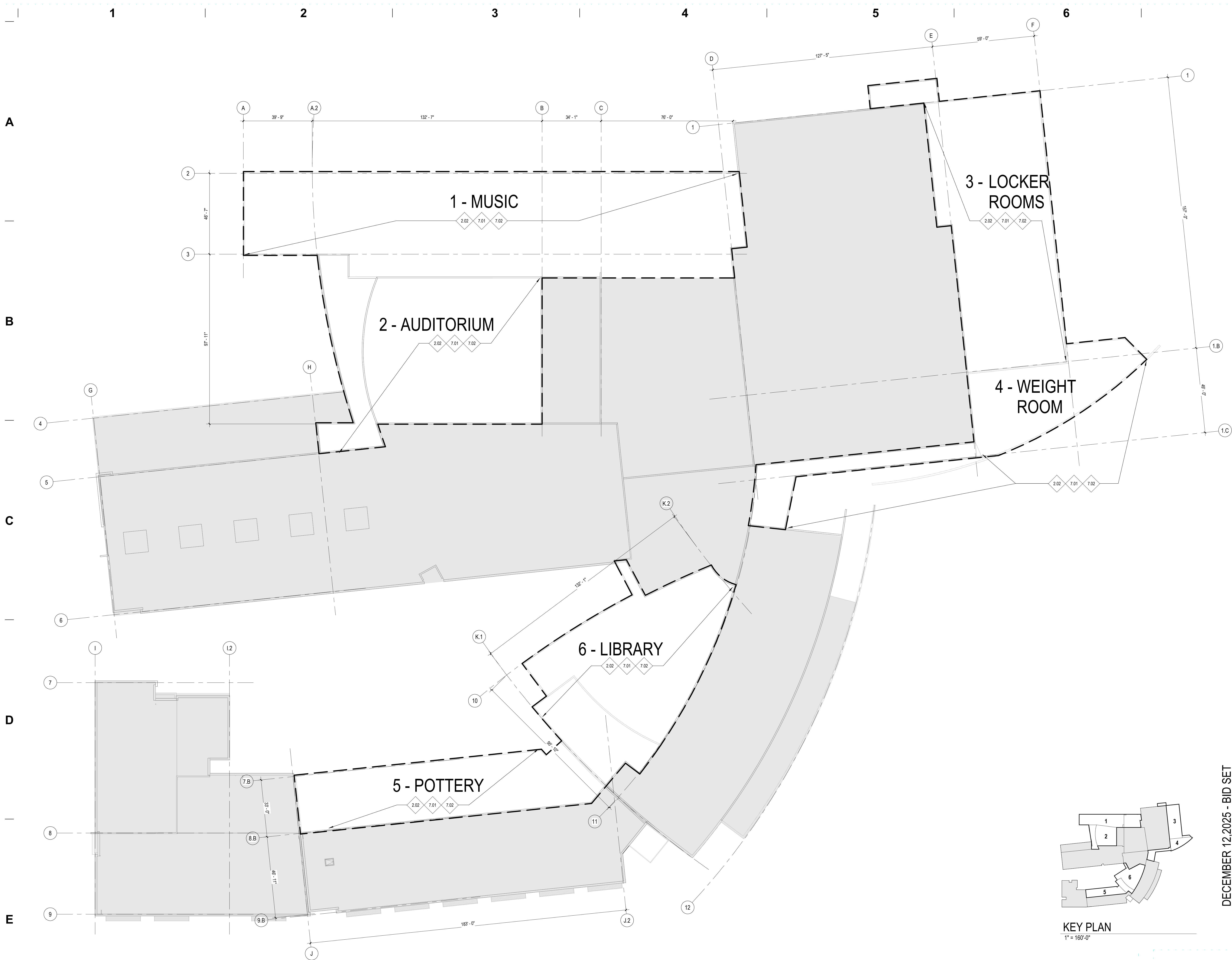

E1 COMPOSITE ROOF PLAN
A2.03 1" = 20'-0"

GENERAL NOTES

1. VERIFY CONDITION OF EXISTING ROOF DECK AFTER DEMOLITION AND REPLACE ANY DETERIORATED AREAS OF THE INSULATION.
2. PROTECT ALL ADJACENT SURFACES, EQUIPMENT, AND AREAS NOT IN THE SCOPE OF WORK FROM DAMAGE. PROVIDE TEMPORARY WEATHER PROTECTION AS REQUIRED.
3. KEEP ALL ROOF DRAINS, SCUPPERS, AND OVERFLOW PATHS CLEAR AND ENSURE THEY ARE PROPERLY INTEGRATED WITH THE NEW ROOF SYSTEM TO MAINTAIN POSITIVE DRAINAGE.
4. FLASH ALL PENETRATIONS WEATHER TIGHT. (I.E., VENT STACKS, VENT PIPES, CONDUIT PENETRATIONS, ETC.)
5. PROVIDE 2'-0" WIDE FLEXIBLE WALKWAY AT ALL ROOFTOP EQUIPMENT CURBS, ROOF HATCHES AND ROOF LADDERS, TYPICAL.
6. ALL NEW WORK ADJACENT TO EXISTING ROOF MUST BE COMPATIBLE TO MAINTAIN EXISTING ROOFING WARRANTY.
7. ALL COPPING CAP DETAILS SHALL BE PER MANUFACTURER.
8. CONTRACTOR SHALL COORDINATE TPO ROOF REPLACEMENT WITH EXISTING MECHANICAL, ELECTRICAL, AND PLUMBING EQUIPMENT ON ROOF. ALL EQUIPMENT IS TO REMAIN. PROVIDE TEMPORARY SUPPORTS, PROTECTION, AND DISCONNECTIONS/RECONNECTIONS AS REQUIRED TO COMPLETE WORK WITHOUT DAMAGE OR INTERRUPTION TO SERVICES.

KEYNOTES

2.02 DEMOLISH AND REMOVE EXISTING ROOFING MEMBRANE, COPING CAPS AND ALL ASSOCIATED MATERIALS. PRESERVE AND PROTECT ROOF INSULATION.

7.01 PROVIDE NEW TPO ROOFING MEMBRANE PER SPECIFICATION SECTION 075423

7.02 PROVIDE NEW COPING CAPS TO MATCH EXISTING.

LEGEND

AREA OF WORK.

NOT IN SCOPE. PRESERVE AND PROTECT ALL AREAS NOT WITHIN AREA OF WORK.

HUMMEL
ARCHITECTS

205 N. 10th Street
Suite 300
Boise, Idaho 83702
208.543.7023

452 Constitution Way,
Suite 101
Idaho Falls, ID 83402
208.543.7023

hummelarch.com

Project:
CANYON RIDGE HIGH SCHOOL RE-ROOF

280 NORTH COLLEGE ROAD WEST
TWIN FALLS, IDAHO 83301

Sheet:
COMPOSITE ROOF PLAN

Project No: 25155

Drawn By: NB

Checked By: BC

Date: 12/12/2025

Sheet No:
A2.03

DECEMBER 12, 2025 - BID SET

KEY PLAN
1" = 160'-0"